

How to Clean

- ◆ Clean after every use.
- ◆ Use mild kitchen detergent.
- ◆ Use a sponge or soft cloth.
- ◆ Be sure to clean the product every use.

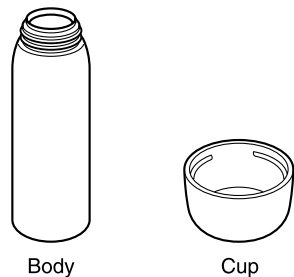

1. Wash it with soft sponge and diluted dish soap or warm water. Rinse well with running water.
2. Wipe off the moisture on the outer surface with dry cloth.
3. Ensure all moisture is wiped from the product after cleaning.

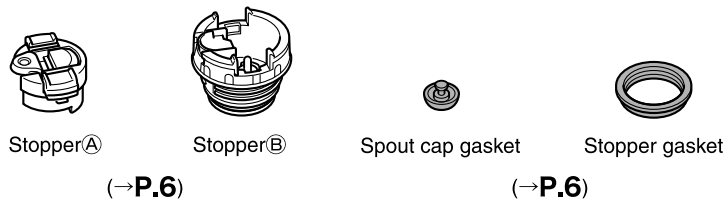

Caution

- Do not leave the product soaked in the cleaning solution.
- Do not use paint thinner, heavy duty cleanser, bleach, duster wipe, metal brush and nylon brush.
- Do not use dish washer, dryer and scalding.
- Always make sure to set the gaskets properly. → P.6
- If you do not use the product for a long time, clean the bottle, cup, stopper and gaskets. Wipe them all with a dry cloth, and allow them to air dry. Then store the product.

Stopper unit

To Remove

Separate stopper unit: squeeze button toward inward as shown, and then lift Stopper A from Stopper B.

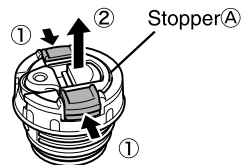

To Attach

Slide down Stopper A to B until it clicks.

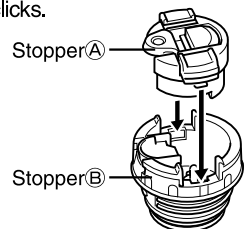

Gasket

Ensure the gaskets are attached properly.

Caution

Be sure the gaskets are properly set it.

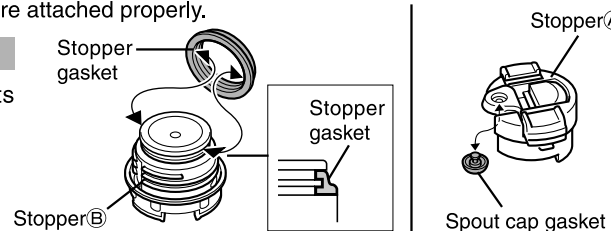

[Reddish rust like spot] or [Rough surface] appear on the product, clean it with Citric Acid.

Decalcifying the unit.

1. Add 10g of Citric Acid and mix with warm water. And then leave Citric Acid solution for 2-3 hours.
2. Wash with soft brush, then rinse out thoroughly with running water.
3. Ensure all moisture is wiped from the product after cleaning.

* Contact customer service.

* Do not use ordinary water heater/bottle cleaner. Ordinary cleaner may contain chlorine bleach and it may damage the gaskets.

The bottle rattles when shaken.

This is caused by a copper sheet moving inside the bottle and it doesn't affect the performance of the bottle. The copper sheet is used for boosting the performance of heat retention.

Replacing and Purchasing Consumable Parts

The gaskets and stopper unit are consumable parts. Check once a year for damage/deterioration. If heavily stained or loose, replace them. For replacement parts, contact customer service or the shop where you purchased this product.

*For the purpose of performance improvement, designs, specifications and parts shown in this publication are subject to change without notice.

Specifications

Capacity	Heat retention
0.6liters/20.3 oz	Greater than 45°C · 113°F(24hours)
	Greater than 73°C · 163°F(6hours)
0.8liters/27.0 oz	Greater than 51°C · 124°F(24hours)
	Greater than 77°C · 171°F(6hours)
1.0liters/33.8 oz	Greater than 57°C · 135°F(24hours)
	Greater than 79°C · 174°F(6hours)

* Heat retention has been calculated under the condition of adding hot water at 95°C ±1°C · 203°F ±2°F and leaving it in a room temperature of 20°C ±2°C · 68°F ±4°F for 24hours or 6hours.

* Capacity is actual volume that water can be stored into the product when the stopper is closed.



TIGER CORPORATION

Head Office: 3-1 Hayamicho, Kadoma-City, Osaka, 571-8571 Japan
URL: <http://www.tiger.jp/global.html>



MODEL

MBK-A

Stainless Steel Bottle

Instructions

Thank you for purchasing a "TIGER" Stainless Steel Bottle. Please read the instructions completely before use. Keep these instructions for future reference.

Features(Name of Parts)

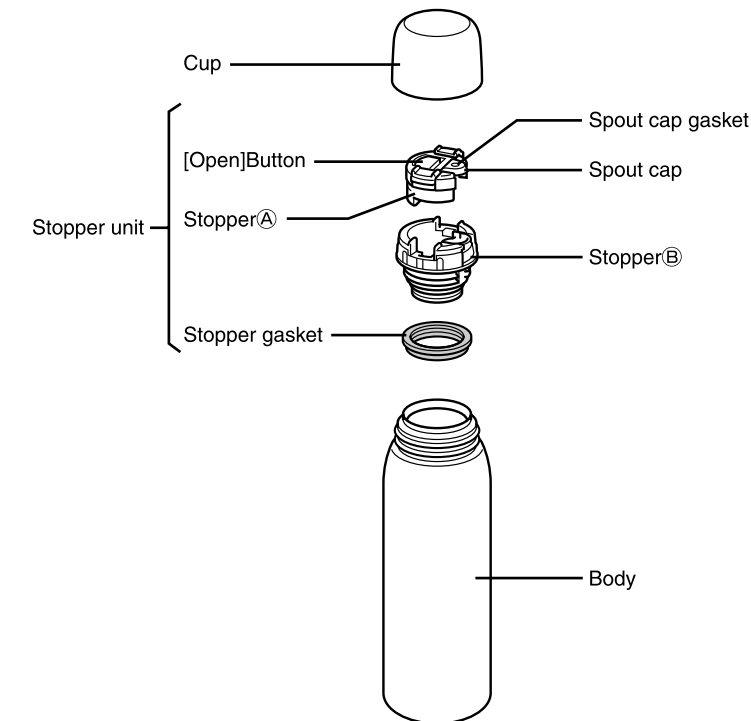

Safety Precautions

Keep out of reach of children.

Be sure stopper unit and cap unit is securely locked.

Do not fill the bottle above the maximum level shown below.

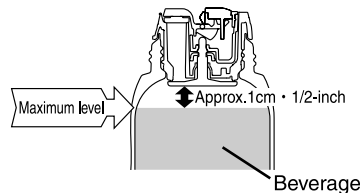

Do not put dry ice or carbonated beverages in the bottle.

Do not place the bottle near stoves, open flames, or other sources of extreme heat.

Do not use the bottle for any purposes other than keeping beverages warm or cold.

Do not disassemble or attempt to repair the bottle by yourself.

Be sure to clean the product immediately specially after sports drink.

Do not store milk, dairy products, or certain fruit juices in the bottle.

Do not store soups or beverages containing salt in the bottle.

Do not use chlorine-based bleaches when cleaning the bottle.

Do not knock over, drop or expose the bottle to excessive shocks.

Do not remove the protective sheet on the underside of the bottle.

Do not place the bottle on its side.

How to use

1 Remove the stopper unit and cup.



Be sure to clean it prior use.→P.5

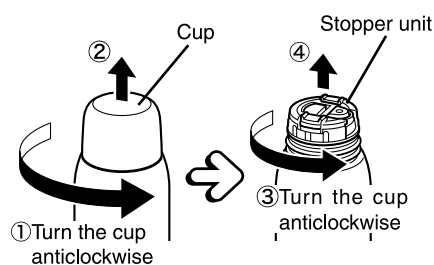

2 To keep your beverage warm or cool longer. Pour hot (or cold) water into the bottle, and let it sit for one or two minutes to allow the inside of the bottle to heat (or cool).

Preheat with hot water. Precool with cold water.

3 Pour desired drink.

- Do not fill the bottle above the maximum level shown right.
- Do not push into big ice cube. Use small or crushed ice.
- Hot tea may change color of tea. Loose tea may clog the stopper. Use tea bag.

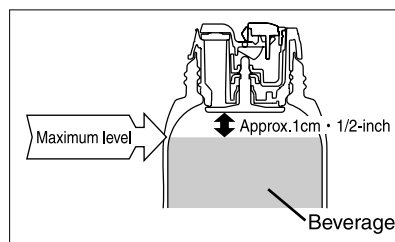

Caution

Wipe off outer body.

4 Close the stopper unit and cup.

Be sure to close securely.

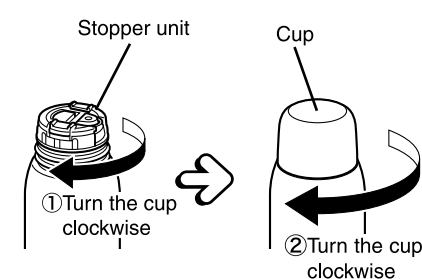

5 Remove the cup, push [Open] Button down, tilt the main body to pour drink.

Caution

Do not push [Open] Button when it tilted. Drink may gush out.

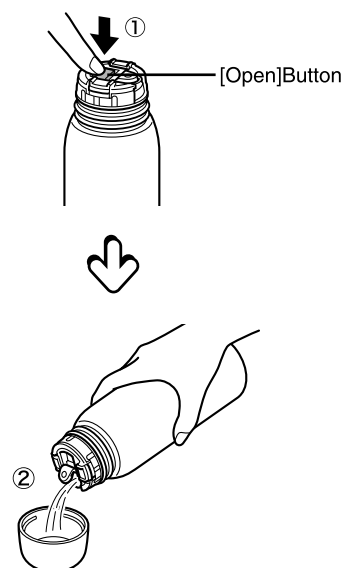

6 Be sure pause 2-3 seconds in upright position, then push Spout cap down.

Caution

Do not push Spout cap when it tilted. Moisture stayed in the stopper unit and it may leak.

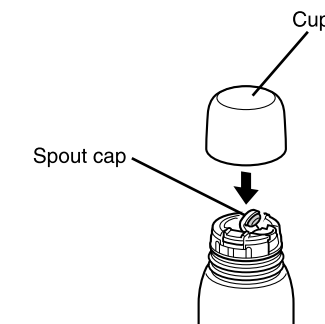
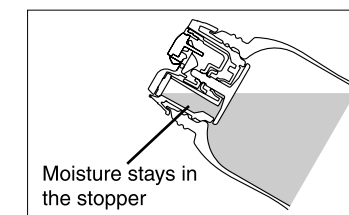

7 Close the cup→P.3

Wipe off inner cup before set it back.

Caution

Keep the main body upright position all the time.

